

FINISH SCHEDULE					
ROOM NAME	FLOOR	BASE	WALL	CEILING	07-13-16
(100) DINING ROOM	T200 24" X 24" TILE	T109 6" X 48" TILE	P101, P104 T109 WP4 W102	PAINT TILE WALL PANEL WALL COVERING	C1 2' X 2' ARMSTRONG, SEPIA #PNB1311 C3 GYP BOARD W/ PAINT P103
(101) SERVING AREA	QT 8" X 8" CONT. QUARRY TILE QT1 IN HIGH TRAFFIC AREAS	QT2 6" X 12" CONT. 3/4" RAD. MIN (KITCHEN EQUIPMENT ON 6" NSF APPROVED LEGS)	T109 TILE		C3 GYP BOARD W/ SMOOTH WASHABLE PAINT
(102) DRIVE-THRU STATION	QT 8" X 8" CONT. QUARRY TILE QT1 IN HIGH TRAFFIC AREAS	QT2 6" X 12" CONT. 3/4" RAD. MIN (KITCHEN EQUIPMENT ON 6" NSF APPROVED LEGS)	WP1 FRP PANEL		C2 2' X 4' SUSPENDED GRID WASHABLE VINYL COATED GYP BOARD PANELS
(103) KITCHEN	QT 8" X 8" CONT. QUARRY TILE QT1 IN HIGH TRAFFIC AREAS	QT2 6" X 12" CONT. 3/4" RAD. MIN (KITCHEN EQUIPMENT ON 6" NSF APPROVED LEGS)	WP3 S.S. BEHIND COOK LINE WP1 FRP PANEL		C2 2' X 4' SUSPENDED GRID WASHABLE VINYL COATED GYP BOARD PANELS
(104) KITCHEN PREP.	QT 8" X 8" CONT. QUARRY TILE QT1 IN HIGH TRAFFIC AREAS	QT2 6" X 12" CONT. 3/4" RAD. MIN (KITCHEN EQUIPMENT ON 6" NSF APPROVED LEGS)	WP1 FRP PANEL		C2 2' X 4' SUSPENDED GRID WASHABLE VINYL COATED GYP BOARD PANELS
(105) WALK-IN COOLER	QT 8" X 8" CONT. QUARRY TILE QT1 IN HIGH TRAFFIC AREAS	S.S. / ALUMINUM WITH 3/4" RADIUS	EXT S.S. INT ALUMINUM GALVANIZED S.S.		ALUMINUM GALVANIZED STAINLESS STEEL
(105A) WALK-IN FREEZER	GALVANIZED STAINLESS STEEL QT 8" X 8" CONT. QUARRY TILE UNDER WIF SUBFLOOR	S.S. / ALUMINUM WITH 3/4" RADIUS	EXT S.S. INT ALUMINUM GALVANIZED S.S.		ALUMINUM GALVANIZED STAINLESS STEEL
(106) MEN'S ROOM	T200 24" X 24" TILE	SCHLUTER	T108 TILE		C3 GYP BOARD W/ P101 SMOOTH WASHABLE PAINT
(107) WOMEN'S ROOM	T200 24" X 24" TILE	SCHLUTER	T108 TILE		C3 GYP BOARD W/ P101 SMOOTH WASHABLE PAINT
(108) VESTIBULE	T200 24" X 24" TILE	T109 6" X 48" TILE	P104 PAINT GYP BOARD T109 TILE		C3 GYP BOARD W/ P101 SMOOTH WASHABLE PAINT
(109) STORAGE ROOM	T200 24" X 24" TILE	T109 6" X 48" TILE	WP1 FRP PANEL		C3 GYP BOARD W/ P101 SMOOTH WASHABLE PAINT
(110) NOT USED	-	-	-		-

DOOR SCHEDULE							
NO.	DOOR MATERIAL	SIZE	FRAME	FACE/EDGE	THK.	CORE	LITE
(D1)	ALUMINUM STOREFRONT	3'-6" X 8'-0"	ALUMINUM	DARK BRONZE ALUMINUM	1 3/4"	HOLLOW	GLASS
(D2)	ALUMINUM STOREFRONT	3'-0" X 8'-0"	ALUMINUM	DARK BRONZE ALUMINUM	1 3/4"	HOLLOW	GLASS
(D3)	S.C. WOOD	3'-0" X 7'-0"	H. METAL	L-200, SEE SPECIAL SURFACE SCHEDULE	1 3/4"	SOLID	-
(D4)	S.C. WOOD	2'-6" X 7'-0"	H. METAL	L-200, SEE SPECIAL SURFACE SCHEDULE	1 3/4"	SOLID	-
(D5)	HOLLOW METAL	3'-6" X 7'-0"	H. METAL	METAL PAINTED	1 3/4"	HOLLOW	-
(D6)	-	-	-	-	-	-	-
HOW							
HW-1 PANIC EXIT REQUIRED							
HW-1 PANIC EXIT REQUIRED NO HARDWARE ON EXTERIOR SIDE OF DOOR							
HW-4 UNDERCUT DOOR BOTTOM 1" AT RESTROOM							
HW-6							
HW-3							

HARDWARE SCHEDULE									
SET	HINGES	CLOSERS	PUSH/PULL	LOCKSET	STOPS	THRES	ADA SIGNAGE	KICKPLATE	SILENCERS
HW-1 PANIC EXIT REQ	PEMKO FM95HD1	YALE UNI-3501 FIN/COLOR TO MATCH DOOR	ROCKWOOD 8F168 TYPE 1 HD MOUNTING FINISH/COLOR TO MATCH DOOR	EXIT DEVICE: ADAMS RITE 8600 C-36-8655 WITH 8650 ESCUTCHEON YALE CYLINDER (1) #620 X 1160 NOTE: HW-1 CYLINDERS TO BE SMALL FORMAT 7-PIN MORTISE CYLINDER HOUSING WITH SARGEANT CAM.	IVES FS18S FIN/COLOR TO MATCH DOOR	HOLD PEMKO 168	-	-	-
HW-1 LOOK-ABLE	PEMKO FM95HD1	YALE UNI-3501 FIN/COLOR TO MATCH DOOR	ROCKWOOD 47-33" (33" CTC) THD HD MOUNTING FINISH/COLOR TO MATCH DOOR	DEADBOLT: ADAMS RITE MS1851SW X 4016 4085X4089X2/MS4043 YALE CYLINDER (2) 1194X1160L	IVES FS18S FIN/COLOR TO MATCH DOOR	PEMKO 168	-	-	-
HW-3	PEMKO CFM95HD1	YALE UNI-4410 689 6190	-	LATCH GUARD: MCKINNEY F191 US320 EXIT DEVICE: YALE 2100-42 689 EXIT ALARM: SICTE 624 680 WEATHER STRIPPING: PEMKO 303AS RAIN DRIP: PEMKO 346A	-	PEMKO 168 A	-	IVES 8400 10" X 49" US32D (PUSH SIDE ONLY)	-
HW-4	McKINNEY, MPB79 4.5X4.5 619	YALE 3501-REG 690	-	PRIVACY LOCK YALE AU YMCL 4702LN X 693X497 619	McKINNEY WS02 619	-	McKINNEY-BLACK HCLAV01-M HCLAV01-W	IVES 8400 10" X 34" 619 (BOTH SIDES OF DOOR)	ROCKWOOD 608
HW-5	McKINNEY, MPB79 4.5X4.5 619	YALE 3501-REG 690	MCKINNEY POS3 X SA 619 PUSH/PULL: DP703 619	-	McKINNEY WS02 619	-	-	IVES 8400 10" X 34" 619 (BOTH SIDES OF DOOR)	ROCKWOOD 608
HW-6	McKINNEY, MPB79 4.5X4.5 619	-	-	YALE MO 5301LN 619	McKINNEY WS02 619	-	-	IVES 8400 10" X 28" 619 (PULL SIDE ONLY)	ROCKWOOD 608

WALL SCHEDULE		INSTALLED AND FURNISHED BY: G.C. UNLESS NOTED OTHERWISE	
NO.	DESCRIPTION		
3-5/8" 20GA. METAL STUD WALL W/ 1/2" TYPE "X" GYP. BOARD BOTH SIDES (SEE ARCHITECTURAL DETAILS & ELEVATIONS)			
3-5/8" 20GA. METAL STUD WALL W/ 1/2" TYPE "X" GYP. BOARD ON ONE SIDE (SEE ARCHITECTURAL DETAILS & ELEVATIONS)			
(2) 3-5/8" 20GA. METAL STUD WALLS W/ 1/2" TYPE "X" GYP. BOARD BOTH SIDES (SEE ARCHITECTURAL DETAILS & ELEVATIONS)			
3-5/8" 20GA. METAL STUD LOW WALL W/ 1/2" TYPE "X" GYP. BD BOTH SIDES. PROVIDE 3 1/2" KNEE-WALL BRACE/POST @ CORNERS AND @ 48" O.C.			
6" 20GA. METAL STUD WALL W/ 1/2" TYPE "X" GYP. BOARD BOTH SIDES (SEE ARCHITECTURAL DETAILS & ELEVATIONS)			
6" 20GA. METAL STUD WALL W/ 1/2" TYPE "X" GYP. BOARD ONE SIDE (SEE ARCHITECTURAL DETAILS & ELEVATIONS)			
6" 20GA. METAL STUD LOW WALL W/ 1/2" TYPE "X" GYP. BOARD BOTH SIDES. PROVIDE 3 1/2" KNEE-WALL BRACE/POST @ CORNERS AND @ 48" O.C.			

WALL PANEL SCHEDULE					INSTALLED AND FURNISHED BY: G.C. UNLESS NOTED OTHERWISE	
NO.	MANUFACTURER	DESCRIPTION	MFG #	COLOR FINISH	REMARK	
(WP1)	CRANE COMPOSITES INC.	F.R.P. THICKNESS: .075	LBGS.14	#636 (GRAY), SM/SM	CONTACT: LINDA RUSE 310.857.9036	
(WP2)	-	S.S. PANEL (22 GA)	-	BRUSHED FINISH	FURNISHED BY PX, INSTALLED BY G.C.	
(WP3)	-	S.S. PANEL (22 GA)	-	DIAMOND PATTERN FINISH	FURNISHED BY PX, INSTALLED BY G.C.	
(WP4)	NOT USED					
(WP5)	NOT USED					
(WP6)	NOT USED					
(W102)	WOLF GORDON	PRINT WALLCOVERING	-	-	CONTACT: CATHY DY 310.770.1165 cathy.dy@wolfgordon.com	

SPECIAL SURFACE SCHEDULE						INSTALLED AND FURNISHED BY: G.C. UNLESS NOTED OTHERWISE	
NO	MANUFACTURER	PRODUCT	MFG #	STAIN / COLOR	FINISH	REMARK	
(CZ-5)	SAMSUNG RADIANTZ	ARTIFICIAL QUARTZ	YE-215	TETON BEIGE	POLISHED	SERVICE COUNTER & DRINK STATION PROVIDED BY PX, INSTALLED BY G.C.	
(CZ-6)	SAMSUNG RADIANTZ	ARTIFICIAL QUARTZ	UG-950	URAL GRAY	POLISHED	TEA COUNTER PROVIDED BY PX, INSTALLED BY G.C.	
(CZ-7)	SAMSUNG RADIANTZ	ARTIFICIAL QUARTZ	-	BLACK GALAXY GRANITE	POLISHED	LAVATORY UNDER MOUNT COUNTER PROVIDED BY PX, INSTALLED BY G.C.	
(R-109)	SCHLUTER	DILEX-AHK COVE TILE TRIM	AHK IS 100 ATGB	ANODIZED ALUMINUM	BRUSHED NICKEL	REF. SHEET A-104 FOR MORE INFO	
(R-110)	SCHLUTER	RONDEC EDGE TILE TRIM	R0100 ATGB	ANODIZED ALUMINUM	BRUSHED NICKEL	REF. SHEET A-104 FOR MORE INFO	
(C-200)	WILSONART	PLASTIC LAMINATE	7949K-18	ASIAN NIGHT	-	INTERIOR RESTROOM DOORS (BOTH SIDES)	

INTERIOR PAINT SCHEDULE					INSTALLED AND FURNISHED BY: G.C. UNLESS NOTED OTHERWISE	
NO	MANUFACTURER	MFG #	COLOR	FINISH	REMARK	
(P9A)	SHERWIN-WILLIAMS	SW 7065	ARGOS	PROMAR 200, ZERO VOC, LATEX SEMI-GLOSS	REAR SERVICE DOOR	
(P9B)	NOT USED					
(P101)	SHERWIN-WILLIAMS	SW 6252	ICE CUBE	PROMAR 200, ZERO VOC, LATEX EGG-SHELL	RESTROOM & RESTROOM VESTIBULE CEILING	
(P102)	NOT USED					
(P103)	SHERWIN-WILLIAMS	SW 7032	WARM STONE	PROMAR 200, ZERO VOC, LATEX EGG-SHELL	DROPPED SOFFITS	
(P104)	SHERWIN-WILLIAMS	SW 6155	RICE GRAIN	PROMAR 200, ZERO VOC, LATEX EGG-SHELL	MENU BOARD SOFFIT, DINING RM. WALLS, RESTROOM VESTIBULE WALLS	
(P105)	NOT USED					
(P106)	SHERWIN-WILLIAMS	SW 7020	BLACK FOX	DTM ACRYLIC GLOSS, LOW VOC	RESTROOM DOOR FRAMES & LCD NICHE (BACK WALL)	
(P205)	SHERWIN-WILLIAMS	SW 7675	SEALSKIN	PROMAR 200, ZERO VOC, LATEX EGG-SHELL	FRONT & BACK & UNDERSIDE FACES OF SERVICE COUNTER SOFFIT	

WALL LEGEND

	NEW EXTERIOR WALL
	NEW EXTERIOR WALL FRAMED WITH STRUCTURAL STEEL STUDS
	NEW INTERIOR WALL (FULL HT.)
	NEW INTERIOR WALL (LOW WALL - REF. ELEV. & DETAILS)
	WALK-IN BOX PANEL

NOTE: THE FOLLOWING STAINLESS STEEL PROVIDED BY PX-INSTALLED BY G.C.:

- PANEL DIVIDERS AT WP3
- INSIDE CORNER AT WP3 TO WP2
- FLASHING AT TOP OF BASE WP3
- WP2 PIECE AT LENGTH OF WALL

NOTE: THE FOLLOWING STAINLESS STEEL PROVIDED BY G.C.-INSTALLED BY G.C.:

- INSTALL 18 GA STAINLESS STEEL CORNER GUARD & WALL CAP INSIDE KITCHEN

	18 GA. STAINLESS STEEL CORNER GUARD
	18 GA. STAINLESS STEEL CORNER GUARD/FRAME - ALL AROUND PERIMETER OF OPENING - FRAME TO BE WELDED WITH MITERED CORNERS TO FORM SINGLE UNIT.
	18 GA. STAINLESS STEEL WALL CAP
	18 GA. STAINLESS STEEL INSIDE CORNER CLOSURE - FROM TOP OF QT BASE TO UNDERSIDE OF CEILING, AT WALK-INS

NOTE: THESE 2 PIECES BY G.C.

ALL OTHER STAINLESS STEEL BY G.C.

NOTE: ALL MISC STAINLESS (CAPS, CORNERS ETC) SHALL BE 18 GA TYPE 304 BRUSHED STAINLESS STEEL.

*AT L-SHAPED LOW WALL AT DRIVE-THRU, PROVIDE WELDED AND GROUND SMOOTH WALL CAP; SHOULD "APPEAR AS THOUGH ONE PIECE"

NOTE: "G.C. TO INSTALL MIN 3 1/2" NON-COMBUSTIBLE MINERAL FIBERGLASS BATTS SOUND INSULATION AT ALL RESTROOM PARTITIONS AND CEILINGS.

*ALL INTERIOR DIMENSIONS ARE FINISHED TO FINISHED

TILE SCHEDULE (SEE SHEET A-104)

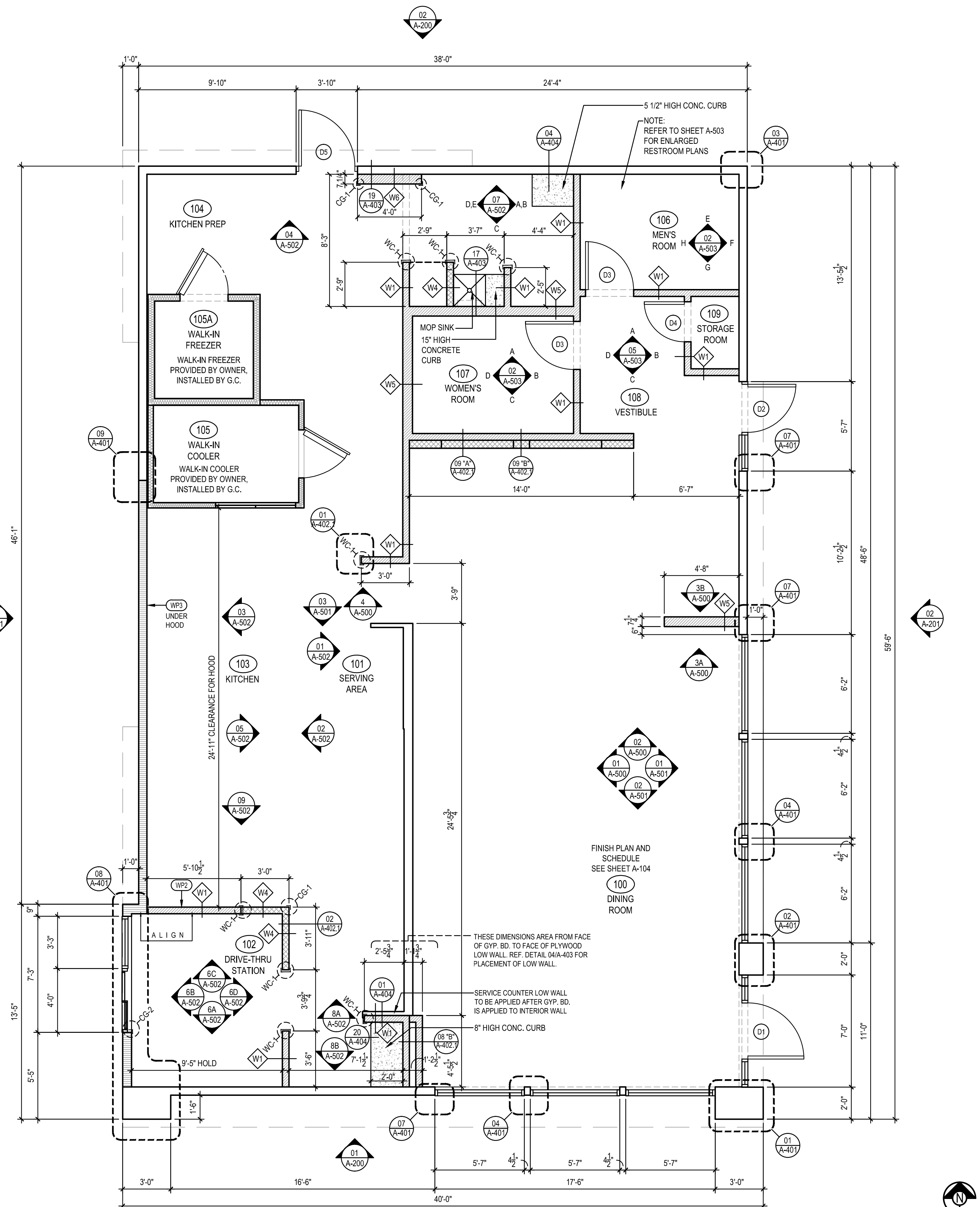

FLOOR PLAN 1

Scale= 1/4" = 1'-0" A-103



PANDA RESTAURANT GROUP INC.
1683 Walnut Grove Ave.
Rosemead, California
91770
Telephone: 626.799.9898
Facsimile: 626.372.8288

All ideas, designs, arrangement and plans indicated or represented by this drawing are the property of Panda Express Inc. and were created for use on this specific project. None of these ideas, designs, arrangements or plans may be used by or disclosed to any person, firm, or corporation without the written permission of Panda Express Inc.

REVISIONS:

NO.	DESCRIPTION	DATE
1st	ISSUE FOR BID & PERMIT	01-11-17

ISSUE DATE:

1st	ISSUE FOR BID & PERMIT	01-11-17

DRAWN BY: RR

PANDA PROJECT #: S8-17-D5197

ARCH PROJECT #: 1701

RANDY REYNOLDS
ARCHITECT

1702 MILDARE COURT, THOMPSONS STATION, TN 37179
PHONE (615) 591-0675 □ FAX (666) 594-1225

PANDA EXPRESS
HIGHWAY 90 AT SHADOW OAK DRIVE
4890 HIGHWAY 90
PACE (MILTON), FL 32571

2200 TRUE WARM & WELCOME

A-103

FLOOR PLAN