

CORNER RECORD

City of Berkeley

Brief Legal Description City of Oakland Street Monument.

Document Number CR 9543

County of Alameda, California

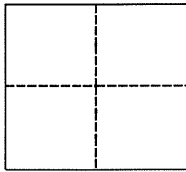

CORNER TYPE

Government Corner ☐
Meander ☐
Rancho ☐

Control ☐
Property ☐
Other ☒

Date of Survey October 14, 2016

COORDINATES (Optional)

N. _____
E. _____
Zone _____ NAD27 ☐ NAD83 ☐
NAD83 Epoch _____
Elev. _____
Vert. Datum: NGVD29 ☐ NAVD88 ☐
Meas. Units: Metric ☐ Imperial ☐

Corner - Left as found ☒ Found and tagged ☐ Established ☐ Reestablished ☐ Rebuilt ☐

Identification and type of corner found: Evidence used to identify or procedure used to establish or reestablish the corner:

In compliance with Section 8771 of the Professional Land Surveyors' Act, this corner record is being filed to ESTABLISH the position of an existing monument PRIOR to street or highway construction.

A description of the physical condition of the monument as found and as set or reset:

See sketch on back.

SURVEYOR'S STATEMENT

This Corner Record was prepared by me or under my direction in conformance with the Professional Land Surveyor's Act on December, 13 2016

Signed William Douglas Crume P.L.S or R.C.E. No. LS 7059

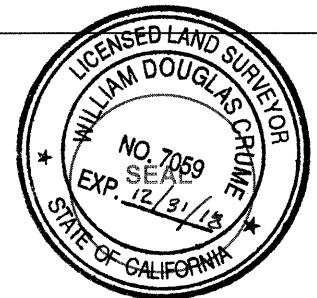

COUNTY SURVEYOR'S STATEMENT

This Corner Record was received 12-16-2016
and examined and filed 01-20-2017

Signed Albert Jordan P.L.S or R.C.E. No. 6623

Title Deputy County Surveyor



County Surveyor's Comment:

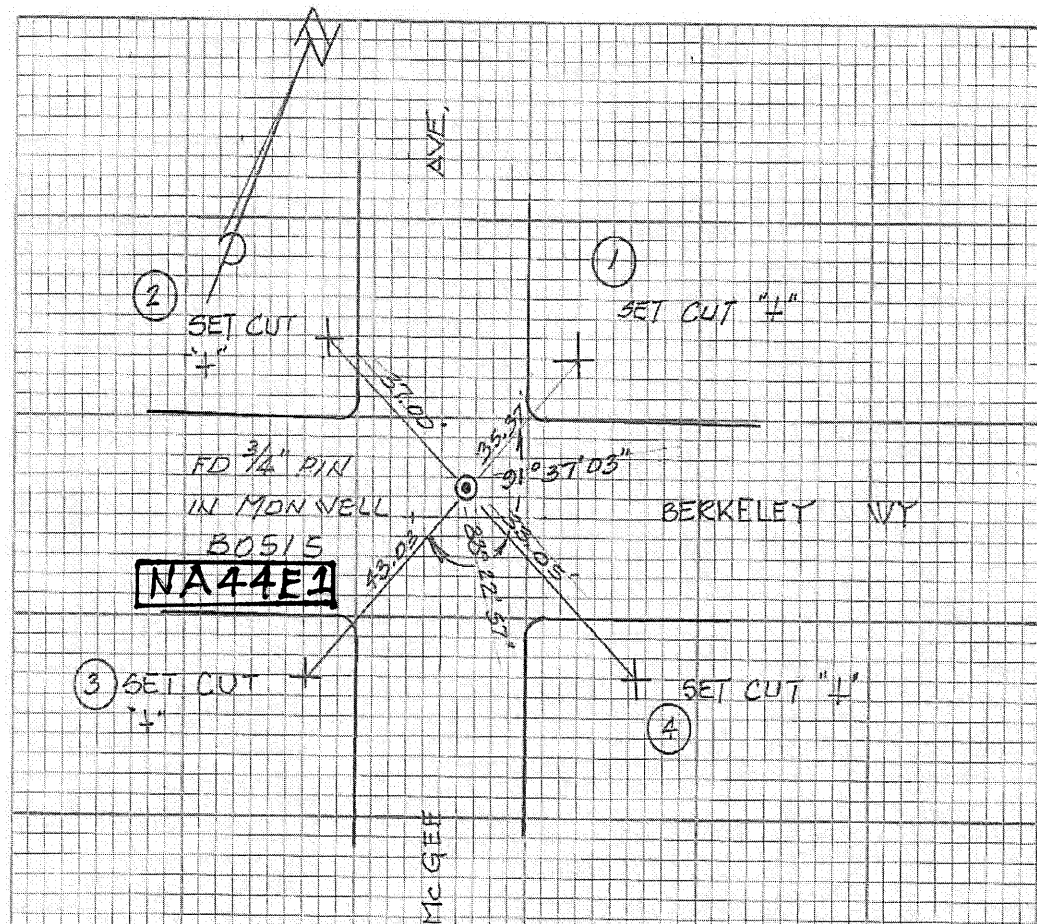

PT	BS	HI	FS	ELEV
BO515	6.62	145.13'		138.51 CoB
1	5.38	144.51'	6.00	139.13'
2	5.62	143.87'	6.26	138.25'
3	6.23	144.42'	5.63	138.19'
4	5.83	145.05'	5.75	139.17'
BO515			6.55	138.50 X (138.51)

LEGEND

⊙ OAKLAND PIN MONUMENT IN WELL

+ SET CUT CROSS

ALAMEDA COUNTY MONUMENT I.D.