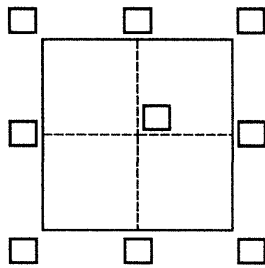

# CORNER RECORD

Agency Index 133 58Document Number CR 14204City of OAKLAND County of ALAMEDA, CaliforniaBrief Legal Description MONUMENT AT THE INTERSECTION OF WOODROE AVE & SPARKS AVE**CORNER TYPE**Government Corner ☒ Control  
Meander ☐ Property  
Rancho ☐ OtherDate of Survey January 7, 2020**COORDINATES (Optional)**

N. \_\_\_\_\_ E. \_\_\_\_\_

Elevation \_\_\_\_\_

Units Metric ☐ U.S. Survey Foot ☒

Horizontal Datum \_\_\_\_\_

Zone \_\_\_\_\_ Epoch Date \_\_\_\_\_

Vertical Datum \_\_\_\_\_

☐ Complies with Public Resources Code §§8801-8819☐ Complies with Public Resources Code §§8890-8902PLS Act Ref.: ☐ 8765(d) ☒ 8771 ☐ 8773 ☐ Other:Corner/  
Monument: ☐ Left as found ☐ Established ☐ Rebuilt ☐ Pre-Construction  
☐ Found and tagged ☐ Reestablished ☐ Referenced ☒ Post-Construction

Narrative of corner identified and monument as found, set, reset, replaced, or removed:

☐ See sheet #2 for description(s):MONUMENT HAD NOT BEEN DISTURBED DURING CONSTRUCTION  
SEE PRE-CONSTRUCTION CORNER RECORD CR 12103**SURVEYOR'S STATEMENT**

This Corner Record was prepared by me or under my direction in conformance with

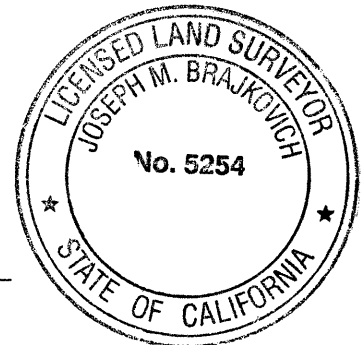
the Professional Land Surveyors' Act on April 8, 2020Signed Joseph M. Brajkovich P.L.S. or R.C.E. No. P.L.S. 5254**COUNTY SURVEYOR'S STATEMENT**This Corner Record was received APR 15 2020and examined and filed APR 15 2020Signed D. Ian Wilson P.L.S. or R.C.E. No. 7010Title ALAMEDA COUNTY SURVEYOR

County Surveyor's Comment



