

CORNER RECORD

Agency Index **BK 120 PG 50**
Document Number **CR 122 40**

City of San Lorenzo County of Hameda, California
Brief Legal Description MON @ Via Media & Via Conejo

CORNER TYPE

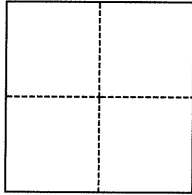

- ☐ Government Corner ☒ Control
☐ Meander ☐ Property
☐ Rancho ☐ Other

Date of Survey 9-6-18

COORDINATES (Optional)

N. 2074045.14 E. 6089092.08

Elevation

Units ☐ Metric ☒ U.S. Survey Foot

Horizontal Datum

Zone 3 Epoch Date

Vertical Datum

☐ Complies with Public Resources Code §§8801-8819

☐ Complies with Public Resources Code §§8890-8902

PLS Act Ref.: ☐ 8765(d) ☒ 8771 ☐ 8773 ☐ Other:
Corner/
Monument: ☒ Left as found ☐ Established ☐ Rebuilt ☐ Pre-Construction
☐ Found and tagged ☐ Reestablished ☐ Referenced ☒ Post-Construction

Narrative of corner identified and monument as found, set, reset, replaced, or removed:
☐ See sheet #2 for description(s):

City Monument - Pre CR10198

SURVEYOR'S STATEMENT

This Corner Record was prepared by me or under my direction in conformance with

the Professional Land Surveyors' Act on 9-13-2018

Signed Joseph M. Brajkovich P.L.S. or P.C.E. No. 5254

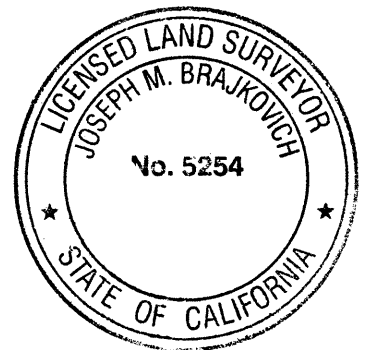

COUNTY SURVEYOR'S STATEMENT

This Corner Record was received 2 OCTOBER 2018

and examined and filed 6 MAY 2019

Signed Michael Rubner P.L.S. or P.C.E. No. 6843

Title COUNTY SURVEYOR

County Surveyor's Comment

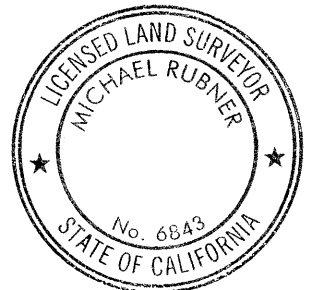

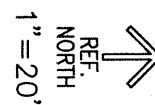

LEGEND

- MONUMENT
- CUT X

